

INSTALLATION INSTRUCTIONS

DESCRIPTION: Chain Guide
PART NUMBER: BW3-F21G0-V0
MODEL: '21+ Ténéré 700



⚠ WARNING

Please read and understand these instructions completely before installation to avoid possible injury, or damage to the accessory or vehicle.

NOTICE:

Installation of this kit requires a torque wrench and should be performed by an authorized Yamaha dealer or a qualified mechanic.

WARRANTY INFORMATION:

In the United States, see your Yamaha dealer for a copy of the Yamaha Genuine Parts and Accessories Limited Warranty.

DEALER OR INSTALLER:

These instructions contain important information for future reference and *must* be given to the customer.

PARTS LIST:

No.	Part Number	Description	Qty
--	BW3-F21G0-V0	Chain Guide Kit	-
①	-	Chain Guide left	1
②	-	Chain Guide right	1
③	-	Cap Washers	2
④	-	M6x20mm Hex Head Flanged Bolt	2
⑤	-	M6x35mm Socket Head Bolt	4
⑥	-	M6 Nylon Locking Nut	4

* Part supplied with kit only and not available separately.

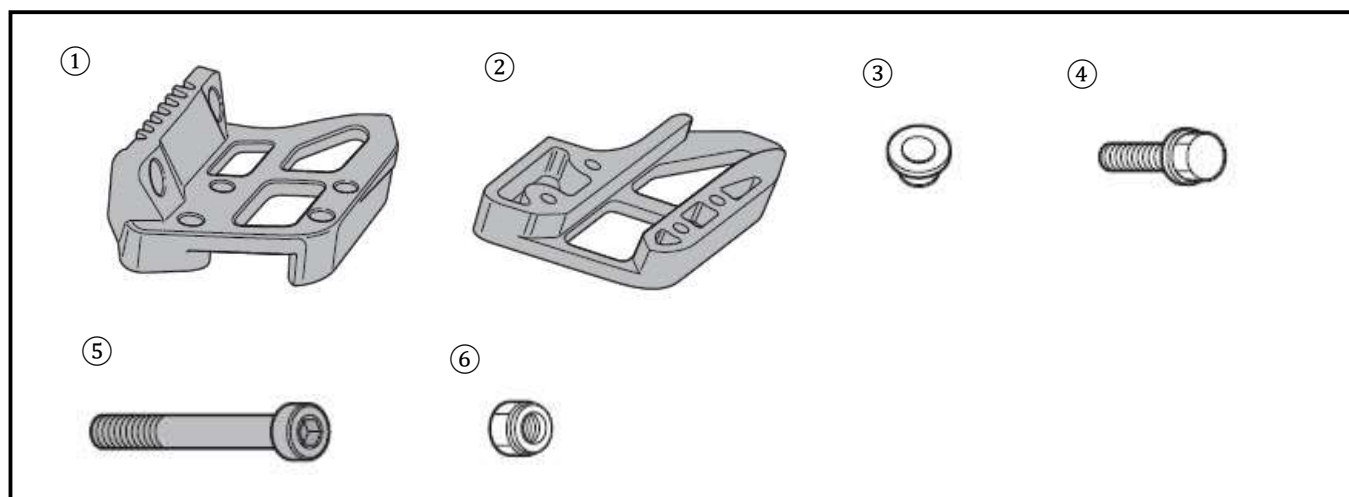

Fig. 1

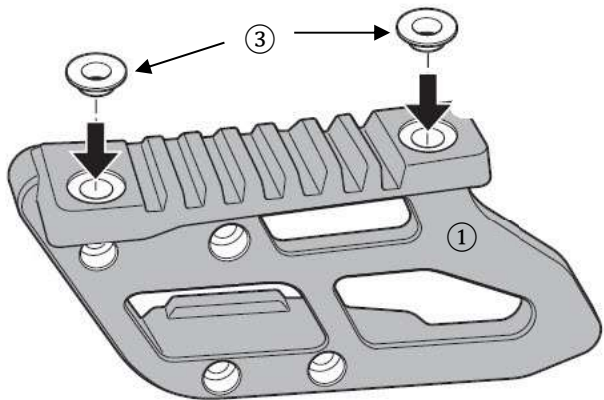

Fig. 2

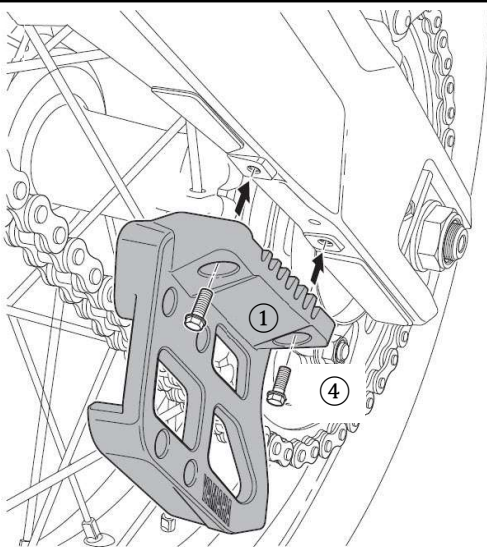
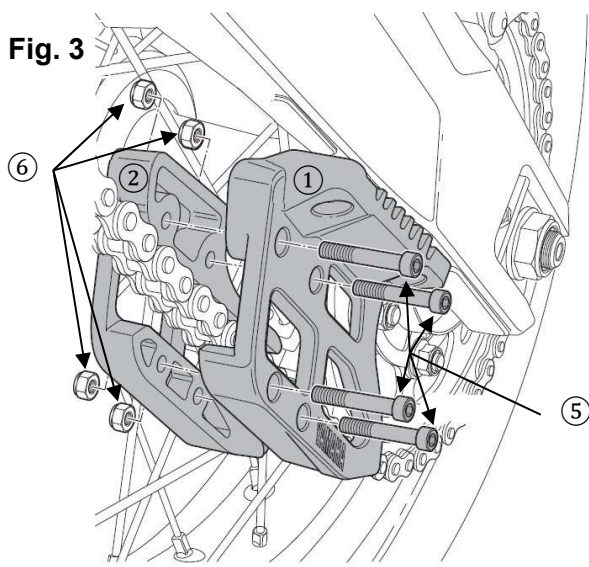

Fig. 3



PREPARATION:

- Place the vehicle on a secure and level surface.
- Clean the mount surfaces before beginning installation.

INSTALLATION:

1. Insert two (3) Cap Washers into the left side of the (1) L Chain Guide.
2. Align and attach the (1) Chain Guide left to the underside of the left swing arm with two (4) M6x20mm Hex Head Flanged Bolts. Tighten to 7 Nm (0.7 kg-m or 5.1 lb-ft)
3. Insert the (2) Chain Guide right behind the (1) Chain Guide left and over the motorcycle chain. Insert four (5) M6x35mm Socket Head Bolts through both parts of the chain guide and thread on four (6) M6 Nylon Locking Nuts.
4. Tighten to 7Nm (0.7 kg-m or 5.1 lb-ft)

MAINTENANCE:

Periodically, check torque on all hardware. If loose hardware is found, re-torque to specification.

CARE AND CLEANING:

Clean painted metal parts with a clean soft cloth and mild soap and water solution. Rinse and dry.

CUSTOMER SERVICE:

For further information see your Yamaha dealer.

ESTIMATED TIME TO INSTALL: 0.5 HRS.